

# IEM-945GSE

ETX 3.0 CPU Module with Intel® Atom™ Processor, VGA/LVDS, LAN, SATA, USB and Audio

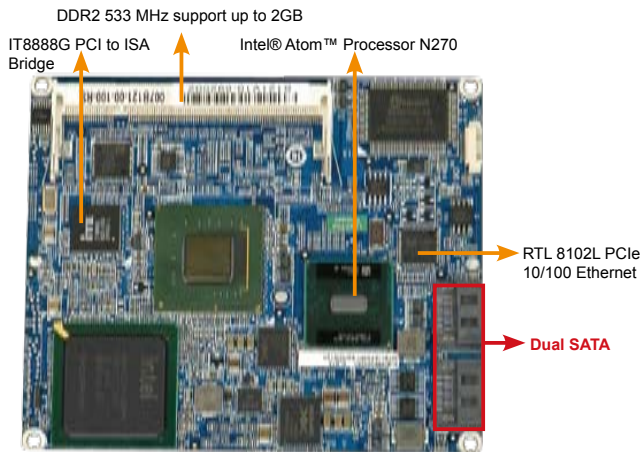

ETX 3.0

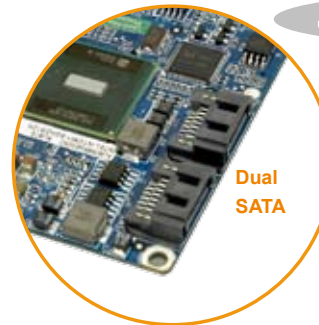

Dual  
SATA

Ship with Heat spreader only

IEM-945GSE ETX 3.0 Module with  
IEM-DB-7S ETX Base board



Solder Side

## Features

1. ETX 3.0 CPU module with on board dual SATA-150 ports
2. Support 4x PCI, 1x ISA slot for expansion
3. Support dual display for VGA + LVDS
4. Support 4 x USB2.0, 2 x SATA, 1 x IDE Interface

## Mechanical drawing

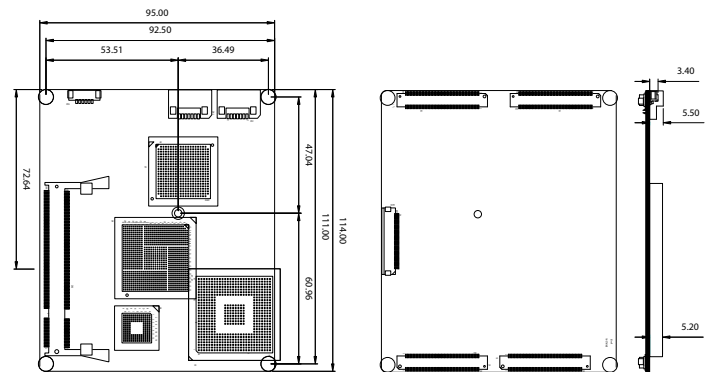

## Specifications

- ◆ CPU  
Intel® Atom™ Processor N270 1.6 GHz with 533 MHz FSB
- ◆ System Chipset  
Intel® 945GSE + Intel® 82801GBM/ICH7M
- ◆ BIOS  
AMI
- ◆ System Memory  
One 200-pin 533/400MHz DDR2 SO-DIMM supported (system max. 2GB)
- ◆ Ethernet  
One 10/100Mbps realtek RTL8102E Ethernet chipset (PCIe Interface)
- ◆ Super I/O  
ITE IT8718
- ◆ I/O Interface  
4 x USB 2.0 (to Base Board)  
2 x SATA (on CPU module)  
1 x IDE (to base board)  
1 x LPT (to base board)  
2 x RS-232 (to base board)  
1 x PS2 KB/MS (to base board)
- ◆ Expansions  
4 x PCI, 32 bit / 33 MHz PCI bus to base board  
ISA support by ITE IT8888G
- ◆ Display Interface  
VGA/TV-Out Integrated in Intel® 945GSE signal (to base board)  
18-bit Dual channel LVDS Signal (to base board)
- ◆ Watchdog Timer  
Software programmable supports 1 ~255 sec. system reset
- ◆ Power Supply  
AT / ATX supported
- ◆ Power Consumption  
5V@2.9A (Intel® Atom™ Processor N270 with 1GB DDR2)
- ◆ Temperature  
Operation: 0°C ~ 60°C ( 32°F ~ 140°F)
- ◆ Humidity  
Operation: 5% ~95% non-condensing
- ◆ Dimensions  
115 mm x 95 mm
- ◆ Weight  
GW: 600g / NW 250g

## Packing List

1 x IEM-945GSE single board computer
1 x Heatspreader
1 x Utility CD
1 x QIG

## Ordering Information

Part No.	Description
IEM-945GSE-N270-R10	ETX 3.0 module with Intel® Atom™ Processor N270 1.6G, VGA/LVDS, LAN, USB, SATA and audio
IEM-945GSE-N270W2-R10	ETX 3.0 module with Intel® Atom™ Processor N270 1.6G, VGA/LVDS, LAN, USB, SATA and audio, -40~85°C
IEM-945GSE-N270W-R10	ETX 3.0 module with Intel® Atom™ Processor N270 1.6G, VGA/LVDS, LAN, USB, SATA and audio, -20~70°C
IEM-DB-7S-RS-R30	ATX size 7 slots ETX baseboard
34000-000180-RS	Heatsink for ETX 3.0 module

1  
Industrial  
Computing  
Solutions

2  
Embedded  
Computing  
Solutions

3  
RISC-Based  
Embedded  
Solutions

4  
Industrial  
Data  
Collector/  
Server  
Solutions

5  
Video  
Capture  
Solutions

6  
I/O  
Communication  
Solutions

7  
Panel  
Solutions

8  
Power Supply/  
Network  
Communication/  
Peripherals